

Regulating Cannabis Businesses

The following maps illustrate locations where development of cannabis retail stores would be restricted, based on the proposed setback regulations:

Hwy 55 & 28 Commercial Area



North Commercial Area

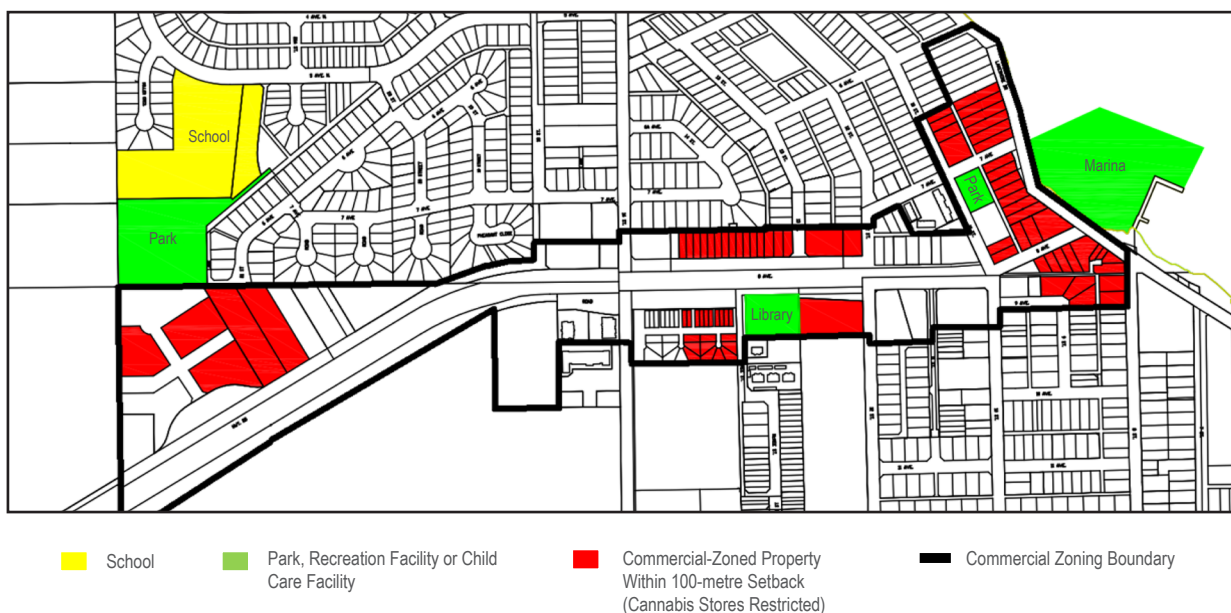

Regulating Cannabis Businesses

The following maps illustrate locations where development of cannabis retail stores would be restricted, based on the proposed setback regulations:

Neighbourhood Commercial Area

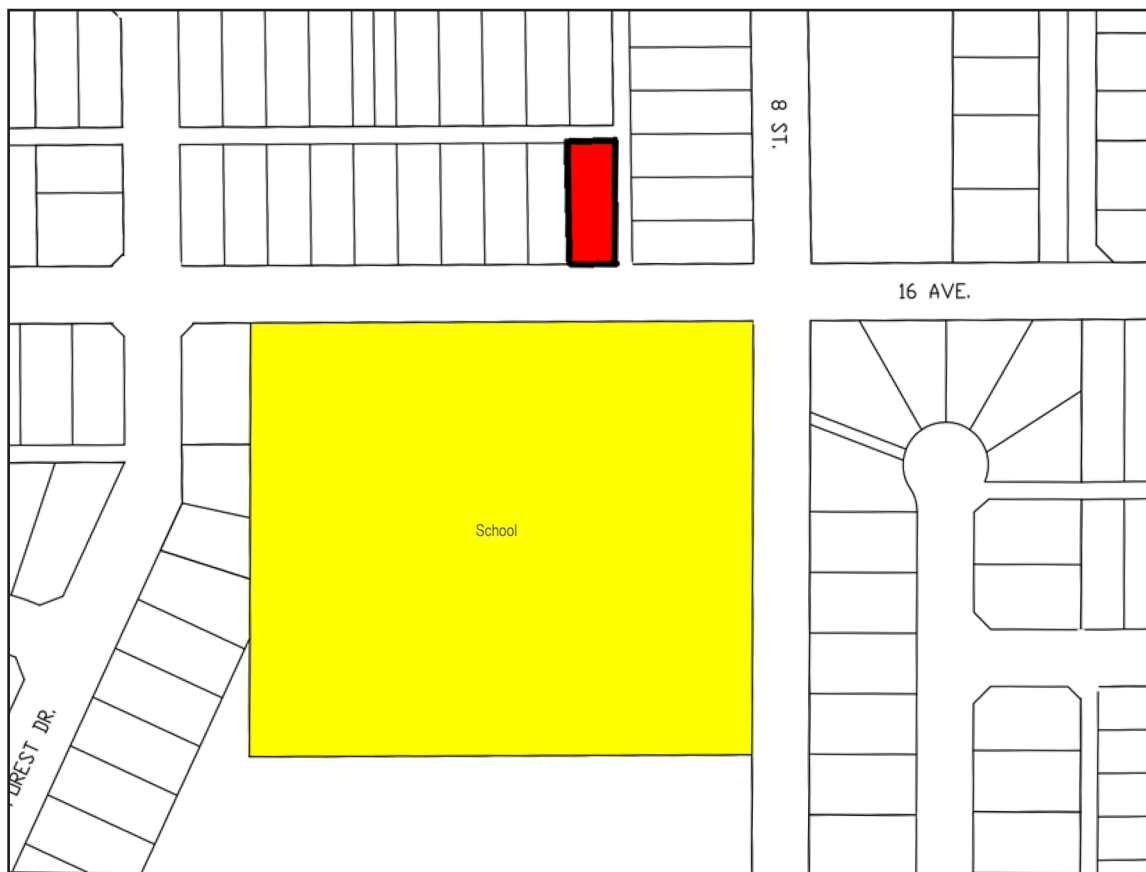

Yellow square: School

Green square: Park, Recreation Facility or Child Care Facility

Red square: Commercial-Zoned Property Within 100-metre Setback (Cannabis Stores Restricted)

Black line: Commercial Zoning Boundary

Regulating Cannabis Businesses

The following maps illustrate locations where development of cannabis retail stores would be restricted, based on the proposed setback regulations:

South Commercial Area

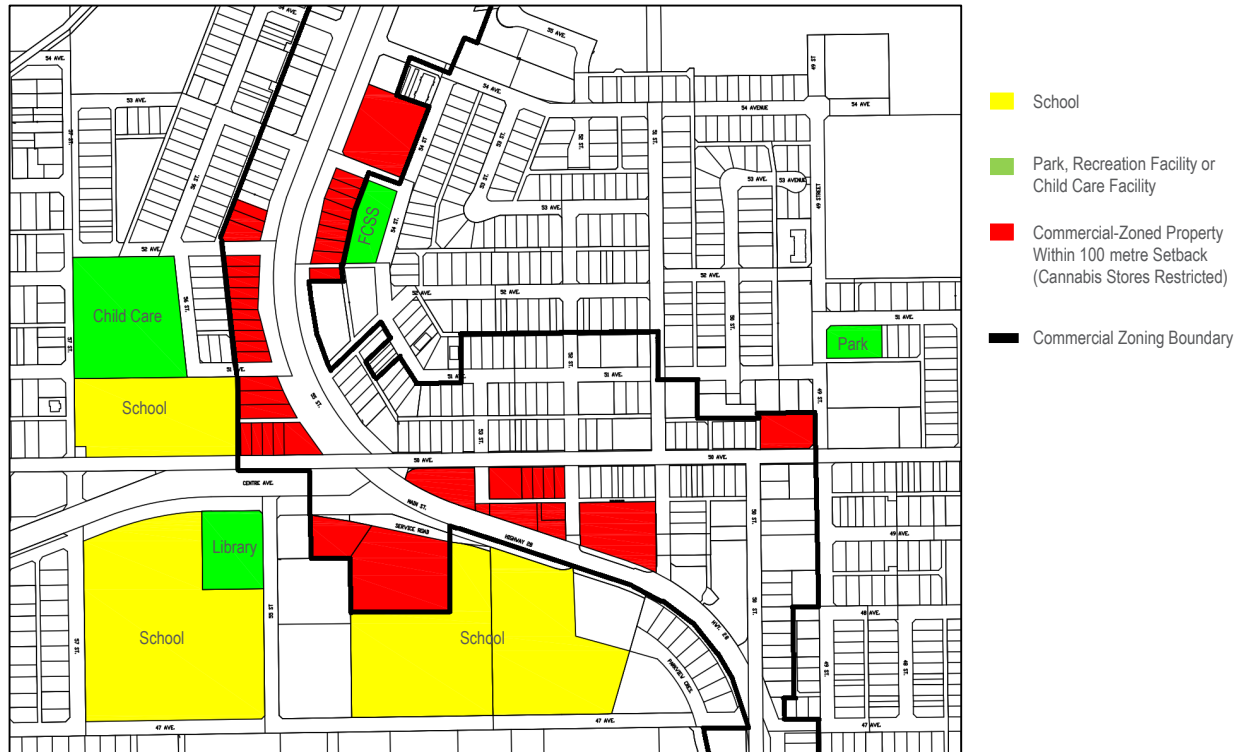

Tri-City Mall Area

